

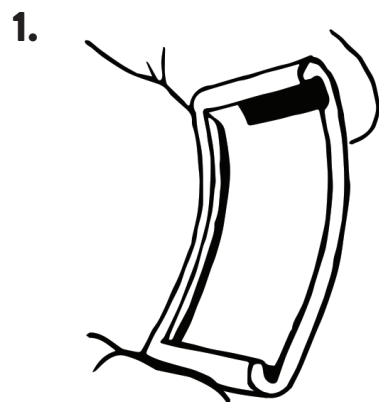

# Blade Installation for a King Arthur Curved Lame

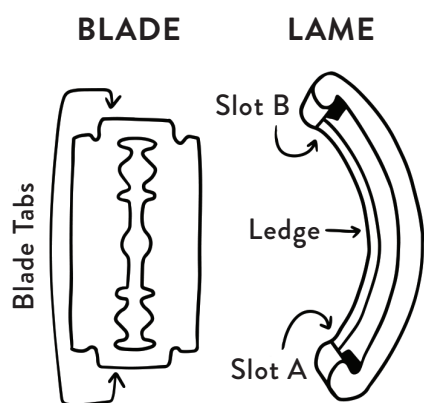

1. With one hand, hold the end of the lame between thumb and index finger.



2. With the other hand, firmly hold the middle of the blade while carefully positioning one end of the blade all the way into slot A.

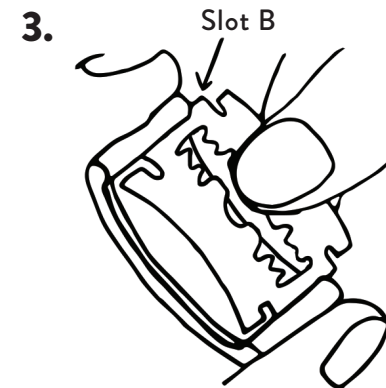

3. Carefully bend the blade in an upward arc and place the other blade tab into slot B.

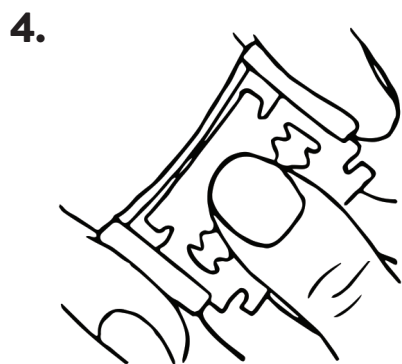

4. Using your thumb, push down on the center of the blade and it will snap into place. The edge of the blade should be resting against the ledge of the lame. You are ready to score!

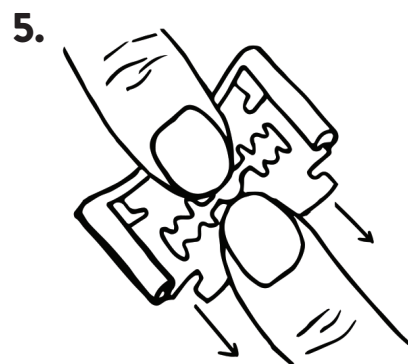

5. To remove the blade, grasp the ledge with one hand and the blade with the other. Give a quick tug and the blade will slide out.

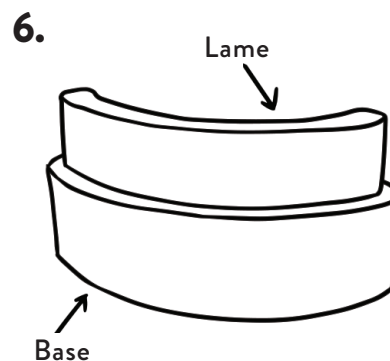

6. You can store the lame with the blade installed on the base.

Keeping lame oiled with food-safe oil will prevent warping and drying. Use a dry, stiff bristle brush to remove any flour residue.

**CAUTION!**  
**RAZOR BLADES ARE VERY SHARP AND CAN INJURE YOU!**

Always keep fingers and body away from the sharp edge of the blade. Keep out of children's reach. Dispose of blades properly. Wire Monkey and the King Arthur Baking Company will not be held responsible for injury.